

**KIEWIT DUFFERIN MIDTOWN PARTNERSHIP  
HIGHWAY 417 FROM ISLAND PARK DRIVE TO KENT STREET  
MTO CONTRACT NO. GC 2020-4075**



**NOTICE OF ROAD CLOSURE ON HIGHWAY 417 Oct 3-6<sup>th</sup>:**

- 1) Lane 1 (left lane) of Eastbound Highway 417 Closed from Rochester to Bank St Overpass.
- 2) Lane 2 (middle lane) of Eastbound Highway 417 Closed Nightly from Rochester to Bank St Overpass.
- 3) Rochester On Ramp Westbound Closed.
- 4) Lane 1 (left lane) of Westbound Highway 417 Closed from Rochester Overpass to O-Train Overpass.
- 5) Lane 2 (middle lane) of Westbound Highway 417 Closed Nightly from Rochester Overpass to O-Train Overpass.
- 6) Lane 2+3 (middle and right lanes) shifted onto shoulder

**Distribution Date: September 30, 2025**

Kiewit Dufferin Midtown Partnership has been retained by the Ontario Ministry of Transportation to replace the Preston Street, Bronson Avenue, and Percy Street bridges on Highway 417, the Ottawa Queensway, as well as undertake operational improvements from the O-Train bridges easterly to the Kent Street bridge and noise barrier replacements from Island Park Drive easterly to Kent Street.

To facilitate this work, KDMP will be required to implement traffic control staging on Highway 417 and City streets. It is KDMP's intent to keep an open and upfront communication channel with all residents and affected agencies. To that end, please see the below information providing further details regarding road closures and the affected area.

- WHERE:** Highway 417 Eastbound from Rochester to Bank, Westbound from Rochester to O-Train.
- WHEN:** Anticipated Start Date: October 3, 2025 @ 9 pm  
Anticipated End Date: October 6, 2025 @ 5am
- WHY:** To facilitate the access for construction of concrete approach slabs on Preston, Bronson, and Percy bridges on the Highway 417.
- WHAT:** Closure of lane 1 (day), Closure of lanes 1 and 2 (nightly)  
Closure of Westbound Rochester On Ramp.
- Excavation and Removals
  - Concrete Approach Slabs
  - Asphalt Paving
  - Line Paint

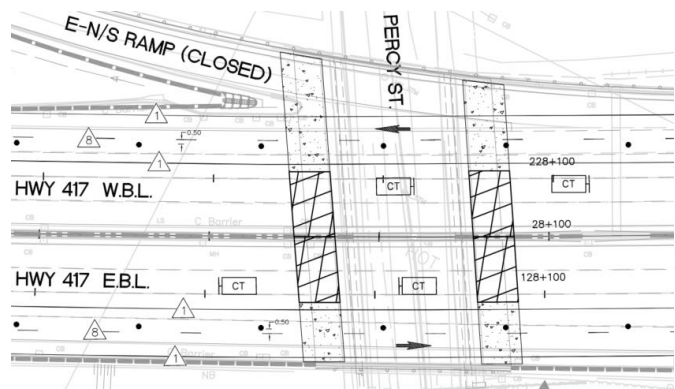
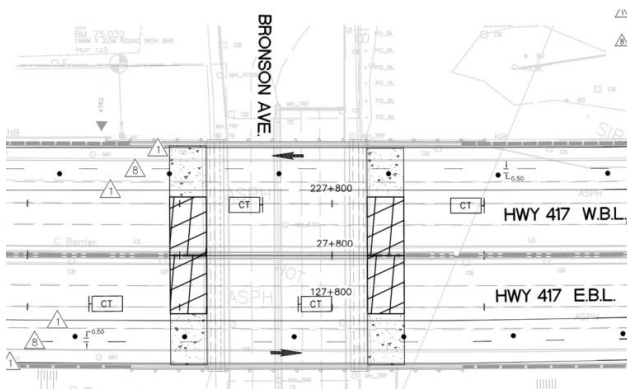

**Highway 417 Detour Map for Eastbound Bronson & Percy, and Westbound Preston Approach Slabs**

**KIEWIT DUFFERIN MIDTOWN PARTNERSHIP  
HIGHWAY 417 FROM ISLAND PARK DRIVE TO KENT STREET  
MTO CONTRACT NO. GC 2020-4075**

